

Bauanfrage

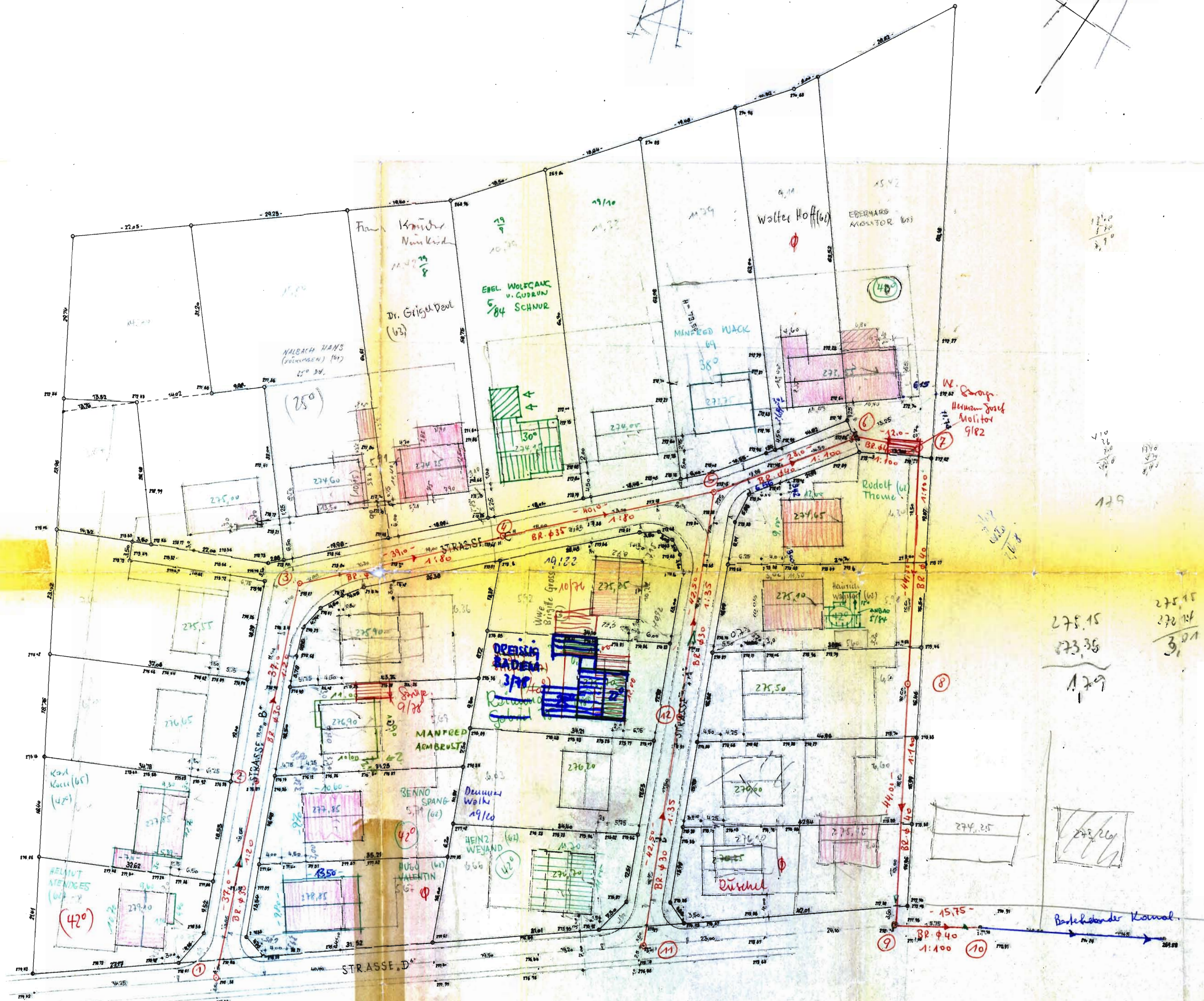

BEBAUUNGSPLAN	
GEMEINDE:	NUNKIRCHEN
BEZEICHNUNG DER LAGE:	"NEUER"
FLUR: 9	BLATT: 1 MASS: AB: 1:500
BEARBEITER:	DER LANDRAT DES KREISES MERZIG-WADERN KREISPLANUNGSSTELLE MERZIG, DEN 4. SEPTEMBER 1901

Handwritten calculations and notes in the bottom left corner, including numbers like 276.90, 274.94, and 1.92.

Handwritten calculations and notes in the bottom center, including numbers like 275.85, 274.73, and 1.94.

Handwritten calculations and notes on the right side, including numbers like 275.15, 273.36, 1.79, 275.15, 272.14, 3.01, 275.16, 274.32, 0.73, 273.55, 270.18, 0.77, 273.55, 272.24, 1.31, 274.05, 273.20, 1.05, 275.15, 272.14, 3.01, 275.16, 274.32, 0.73.

Small handwritten notes at the bottom right corner, including numbers like 274.525, 275, and 900.